

Courses & distances up Creek

- S. 56 W. 59 post
- S. 59 W. 51 1/2 post
- S. 41 W. 25 W.O.
- S. 36 E. 22 W.O.

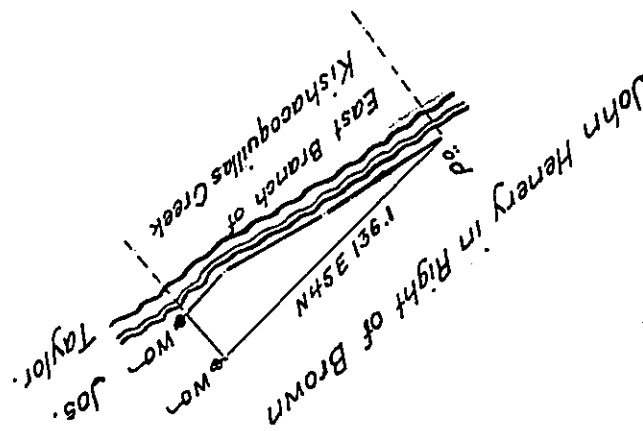

A draught of a tract of land situate in Brown township Mifflin County Contain-
 ing Ten Acres and Eighty Eight perches and the usual allowance of six per cent for roads &c.
 Surveyed the 4th day of June 1846 In pursuance of a Warrant to Henry B. Taylor dated the
 7th day of May 1846

David Hough D.S.

John Laporte Esqr S.G.

IN TESTIMONY that the above is a copy of the original remaining on file in
 the Department of Internal Affairs of Pennsylvania, made
 conformably to an Act of Assembly approved the 16th day of
 February, 1833, I have hereunto set my Hand and caused
 the Seal of said Department to be affixed at Harrisburg,
 this twentieth day of May 1908

Henry Horvath
 Secretary of Internal Affairs.